

Flure EG + OG's

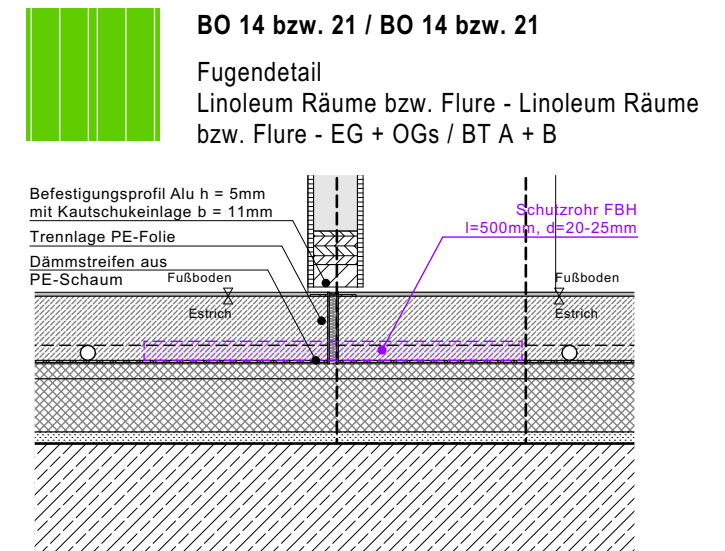

Sanitär EG + OG's

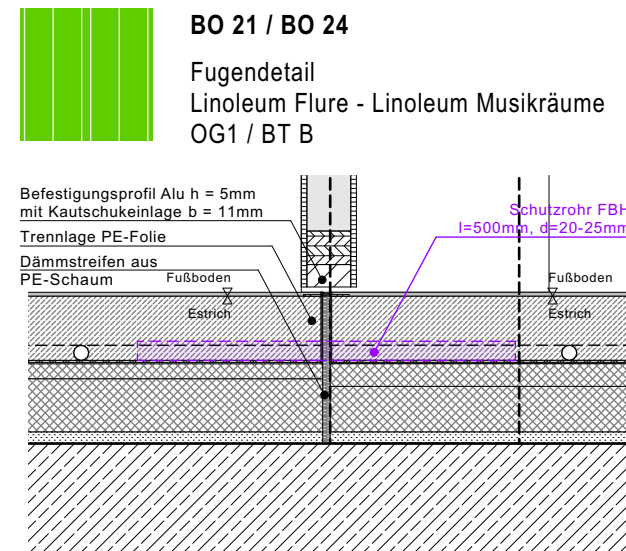
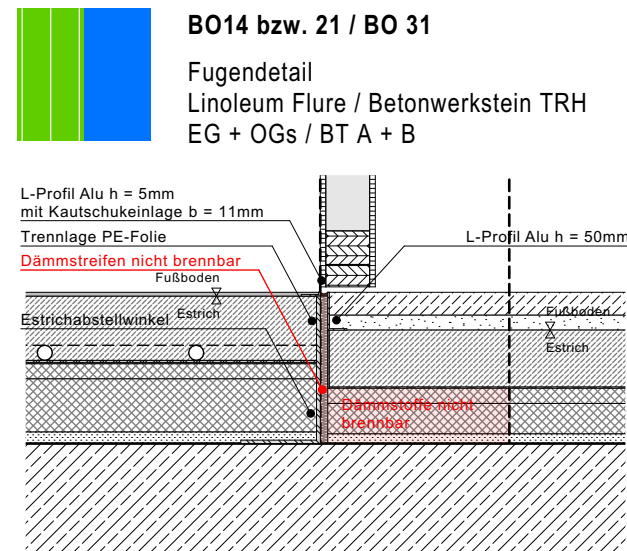
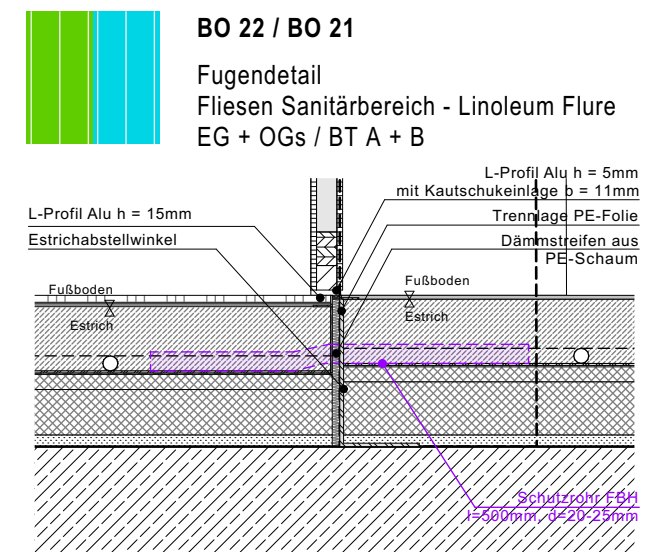
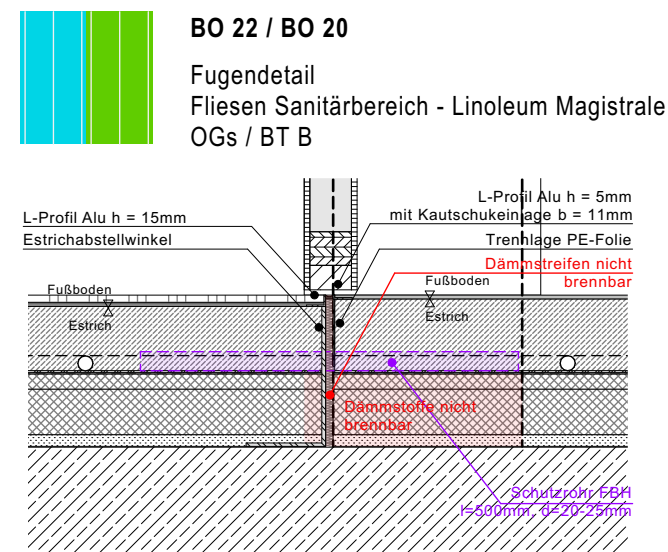
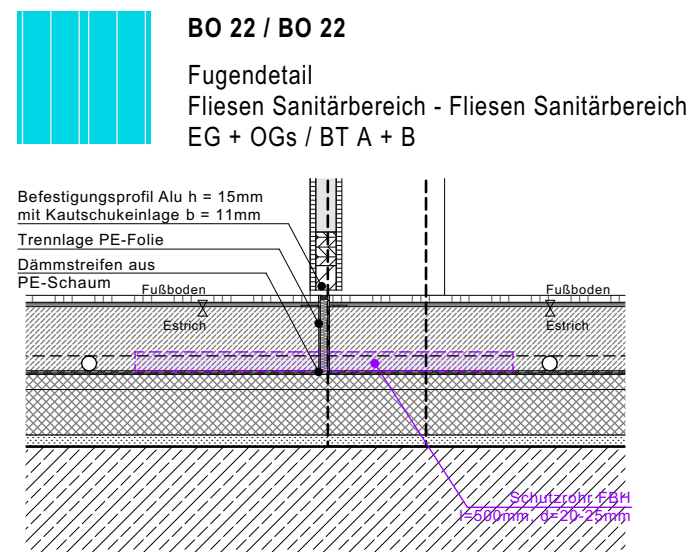

Magistrale OG's

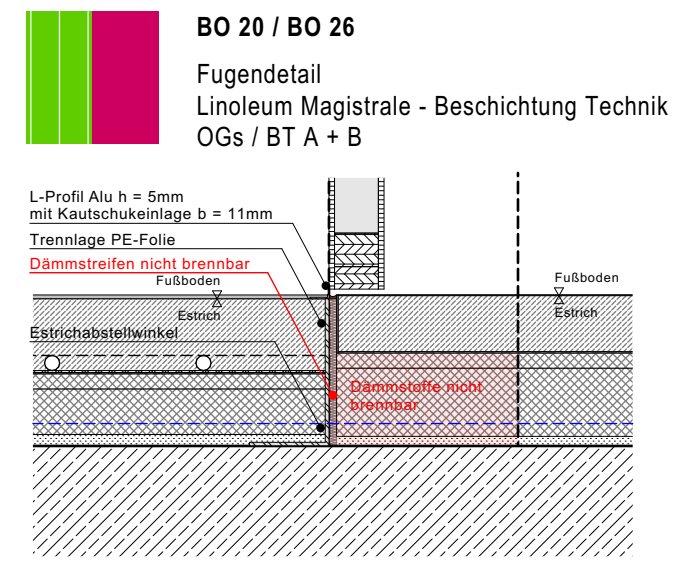
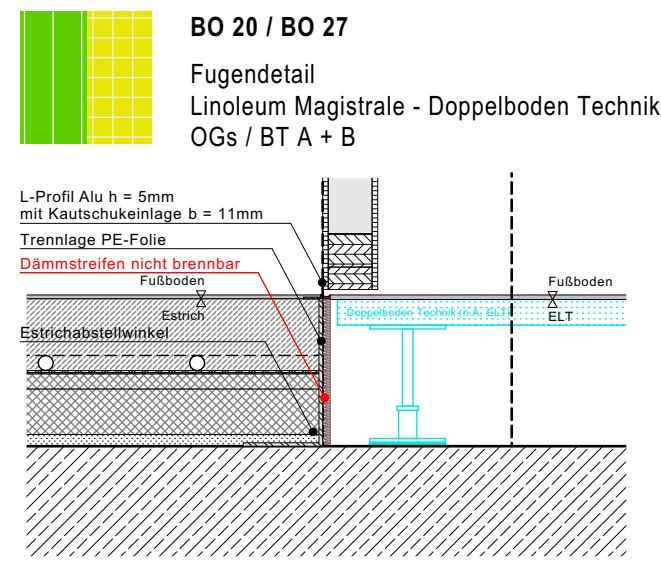
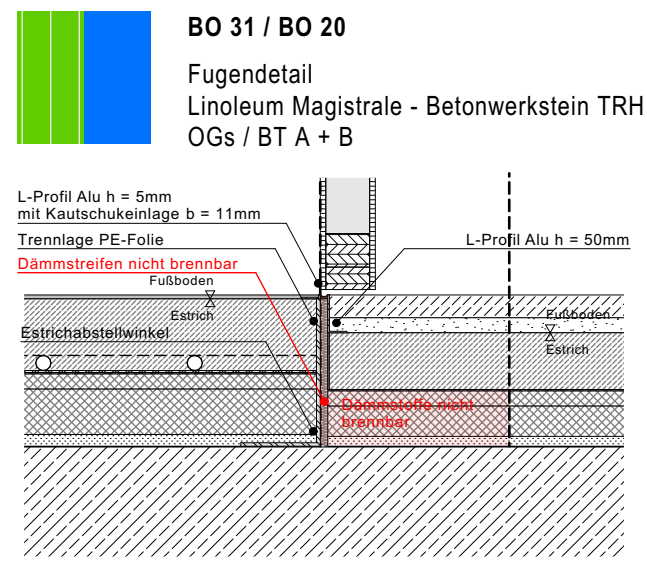

Anmerkungen

Alle Bauteilaufbauten sind nur im Zusammenhang mit den Übersichtsplänen gültig!

Index Historie

Index	Datum	Änderungsvermerk	gez.

1903 II Neubau Michael- Ende-Schule
OK FFB EG =±0,00 = 475,850m üNN

AR6X_DEBO_1562_

Format :

Bodenfugen EG + OGs
M 1:10 05.02.2026